

DIRECTIONS TO CAMPUS

NORTHBOUND

1. From BWI Airport: From the airport ramp, take 195 to the Baltimore/Washington Parkway (MD-295 North). Continue to the West Nursery Road exit. At the end of the exit, bear right onto West Nursery Road. Go to the first traffic light and turn left onto Corporate Boulevard. Proceed to the first street and turn left onto Aero Drive. Enter through the gate, turning right onto Maritime Boulevard.
2. From BWI Amtrak® Station: At the light, turn left onto Route 170 (Aviation Blvd). Continue on Route 170 to 195E. Follow 195 to the Baltimore/Washington Parkway (MD-295 North). Follow MD-295 North to the West Nursery Road exit. At the end of the exit, bear right onto West Nursery Road. Go to the first light and turn left onto Corporate Boulevard. Proceed to the first street and turn left onto Aero Drive. Enter through the gate, turning right onto Maritime Boulevard.
3. From South via the Baltimore/Washington Parkway (MD-295): Go North to the West Nursery Road exit (just after the BWI exit). Bear right at the end of the ramp onto West Nursery Road. Go to the first accessible light and turn left onto Corporate Boulevard. Proceed to the first street and turn left onto Aero Drive. Enter through the gate, turning right onto Maritime Boulevard.
4. From South via I-95: Go North to 195 East. Take 195 East to the Baltimore/Washington Parkway (MD-295 North). Proceed as in number three above.
5. From South via Route 3/301, I-97, Route 2: Go North to MD-100. Go West to Baltimore/Washington Parkway (MD-295 North) and then proceed as in number three above.

(Alternative) – Go North to the Baltimore Beltway (695). Take 695 West towards Baltimore/Towson (not the Key Bridge). Take exit 7, Baltimore/Washington Parkway (MD-295 South). Proceed using Southbound directions.

SOUTHBOUND

1. From the Baltimore-Washington Parkway (MD-295 South): Go South on the Baltimore/Washington Parkway (MD-295 South) to the West Nursery Road exit (first exit south of 695 Baltimore Beltway). At the end of the ramp, turn left at the light onto West Nursery Road. Turn left onto Corporate Boulevard. Go to the first street and turn left onto Aero Drive. Enter through the gate, turning right onto Maritime Boulevard.
2. From North via I-95 using the Ft. McHenry Tunnel: Head South through the Ft. McHenry Tunnel. Take the third exit after the tunnel, Baltimore/Washington Parkway (MD-295 South). Proceed as in number one above.
3. From North via the Baltimore Beltway (695): From 695 (South), 83, 70 or 95, take the Baltimore Beltway (695 South) towards Glen Burnie. Take exit seven, the Baltimore/Washington Parkway (MD-295 South). Proceed as in number one above.
4. From Downtown Baltimore via I-395: Take 395 South to 95 South. Exit left onto the Baltimore Beltway (695 East). Take exit seven, the Baltimore/Washington Parkway (MD-295 South). Proceed as in number one above.



HELIPORT

FAA Identifier: 2MD7 – Maritime Institute of Technology - Call for Instructions

692 Maritime Boulevard, Linthicum Heights, MD 21090
MAIN: 410-859-5700 | WWW.MITAGS.ORG | WWW.MCCBWI.ORG

 @mccbwi  Maritime Conference Center
 @mccbwi.org  Maritime Conference Center



PROPERTY MAP



MITAGS
MARITIME INSTITUTE OF TECHNOLOGY
AND GRADUATE STUDIES

MARITIME
CONFERENCE CENTER

BALTIMORE-WASHINGTON PARKWAY

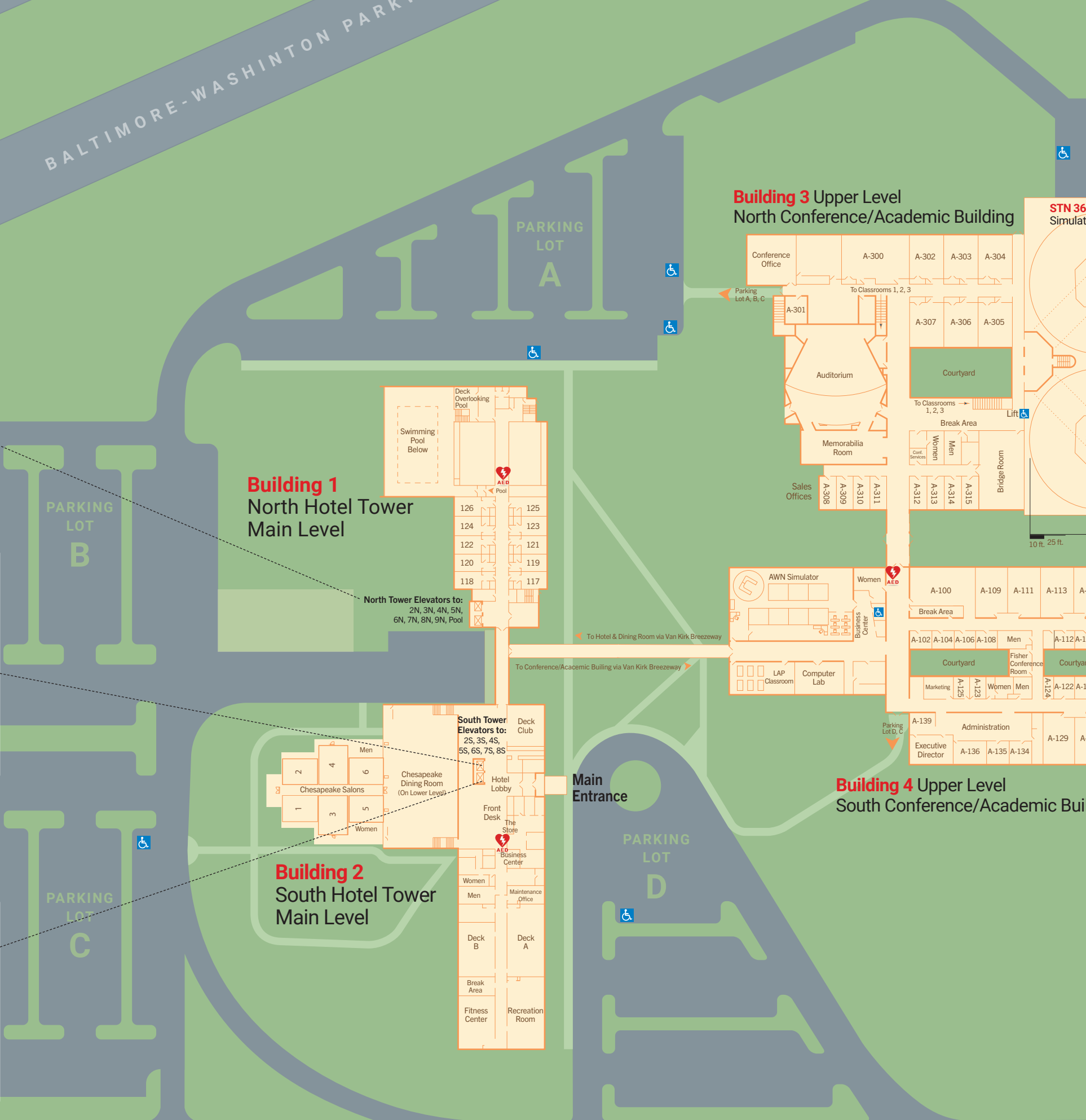
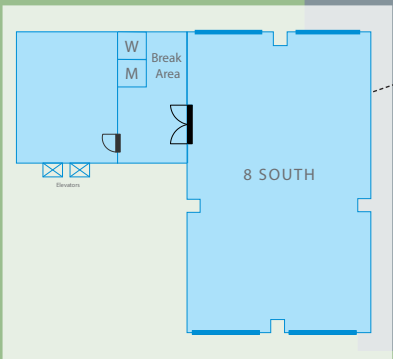
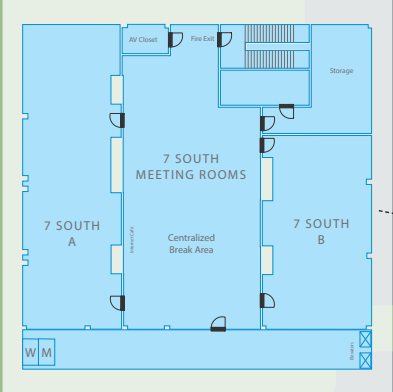
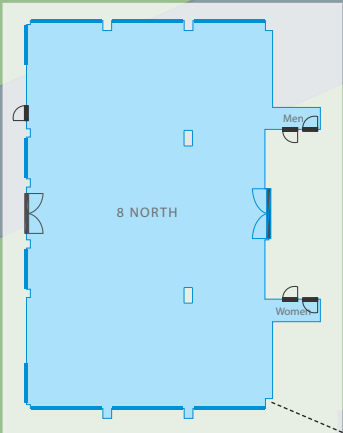

PARKING LOT B

PARKING LOT C

PARKING LOT A

PARKING LOT D

BACK PARKING LOT

Building 1 North Hotel Tower Main Level

North Tower Elevators to: 2N, 3N, 4N, 5N, 6N, 7N, 8N, 9N, Pool

Building 2 South Hotel Tower Main Level

South Tower Elevators to: 2S, 3S, 4S, 5S, 6S, 7S, 8S

Building 3 Upper Level North Conference/Academic Building

STN 360° Full-Mission Simulators (100ft wide each)

Building 3 Lower Level North Conference/Academic Building

Building 4 Upper Level South Conference/Academic Building

Building 4 Lower Level South Conference/Academic Building

← TO WEST NURSERY ROAD

MARITIME BLVD.

TO HAMMONDS FERRY ROAD →

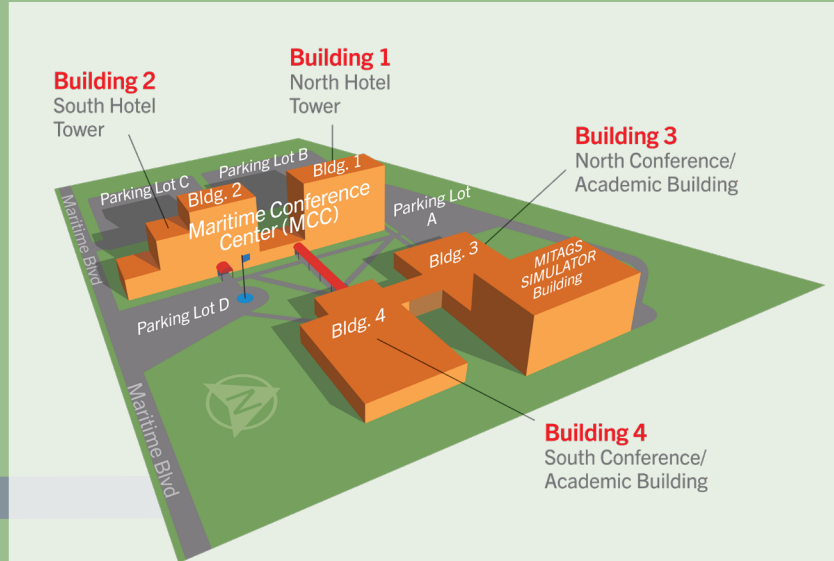

Building 4 South Conference/Academic Building